

PSA-80 PRO

# The Complete Maintenance Guide

# Maintenance Schedule

## Daily Tasks

Equipment	Maintenance Required	Notes
Tables and Robot Base	Clean with damp cloth	Ensures proper table adhesion and prevents dust buildup

## Weekly Tasks

Equipment	Maintenance Required	Notes
Sanders	Clean with compressed air	As needed based on usage

## Monthly Tasks

Equipment	Maintenance Required	Notes
Mirka Dust extractor	Change bag	Change more frequently with heavy usage
Cameras	Check for dust buildup	Use only manual air blower for cleaning
Oil Reservoirs	If used, check and refill as needed	Use specific pneumatic tool lubrication oil

## Annual Tasks

Equipment	Maintenance Required	Notes
Robotic Arm	Replace encoder batteries	Three batteries type A98L-0031-0040#A required
Vacuum Generator	Remove any dust build up inside	Clean more frequently with heavy usage

# Annexe

## Annex A: Important Maintenance Notes

### Tables and robot base

Clean your tables and the robot base daily with a damp cloth to prevent dust buildup and ensure proper table adhesion.

### Sanders

We recommend cleaning the sanders with compressed air occasionally to maintain their durability and optimal performance.

### Mirka Dust extractor

Please change the bag in your Mirka vacuum at least once a month or according to your usage to avoid clogging and maintain efficiency.

### Cameras

If you notice dust buildup on your cameras, do not use your compressed air line, a compressed air can, a cloth, or any object that might damage the lenses. Please use only a manual air blower like the one you can find in this kit:

[https://www.amazon.ca/gp/product/B00MHGOGUK/ref=ppx\\_yo\\_dt\\_b\\_asin\\_title\\_o03\\_s03?ie=UTF8&psc=1](https://www.amazon.ca/gp/product/B00MHGOGUK/ref=ppx_yo_dt_b_asin_title_o03_s03?ie=UTF8&psc=1).

### Oil reservoirs

If you choose to refill the oil reservoirs of both sanders, we recommend refilling it according to your usage. Use lubrication oil specifically for pneumatic tools. Be careful not to overfill to avoid leaks on the panels. Beware, do not refill the oil reservoirs if your exhaust tube is disconnected from your sander. This will cause an oil spill, on your machine, tables and doors.

## Vacuum Generator

Remove dust build up inside the vacuum generator yearly by removing the bottom screws and pulling out the top part of the vacuum generator, see picture below :

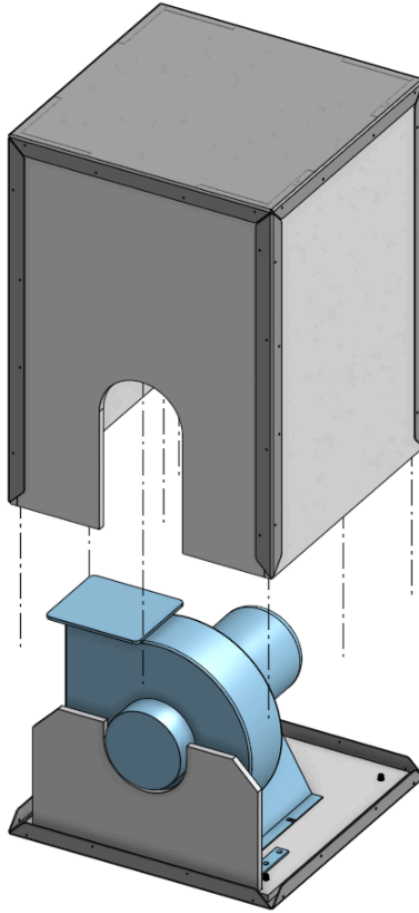

## Robotic arm

The encoder batteries (3 x A98L-0031-0040#A) in your robotic arm should be replaced no later than 12 months after your machine's purchase date. This is a crucial maintenance requirement. You have two options for handling this maintenance:

### 1. Self-Replacement:

You can replace the batteries yourself by following the detailed instructions in the picture below.

## Procedure of replacing the battery (CRX-25iA)

- 1 Press the EMERGENCY STOP button to prohibit the robot motion.



### CAUTION

Be sure to keep the power on. Replacing the batteries with the power supply turned off causes all current position data to be lost. Therefore, mastering will be required again.

- 2 Remove the bolts and the J2 arm base side cover.
- 3 Remove the cable connector of the batteries.
- 4 Remove bolts and cover plate of the battery.
- 5 Open the cable clip and pick out batteries cable.
- 6 Take out the old batteries (3 pcs) from the battery case. Then replace the batteries (3 pcs).
- 7 Assemble them by reversing the sequence. The gasket is reusable. When assembling the J2 arm cover, tighten all bolts in diagonal order to regulated torque 6.8Nm (69kgfcm).

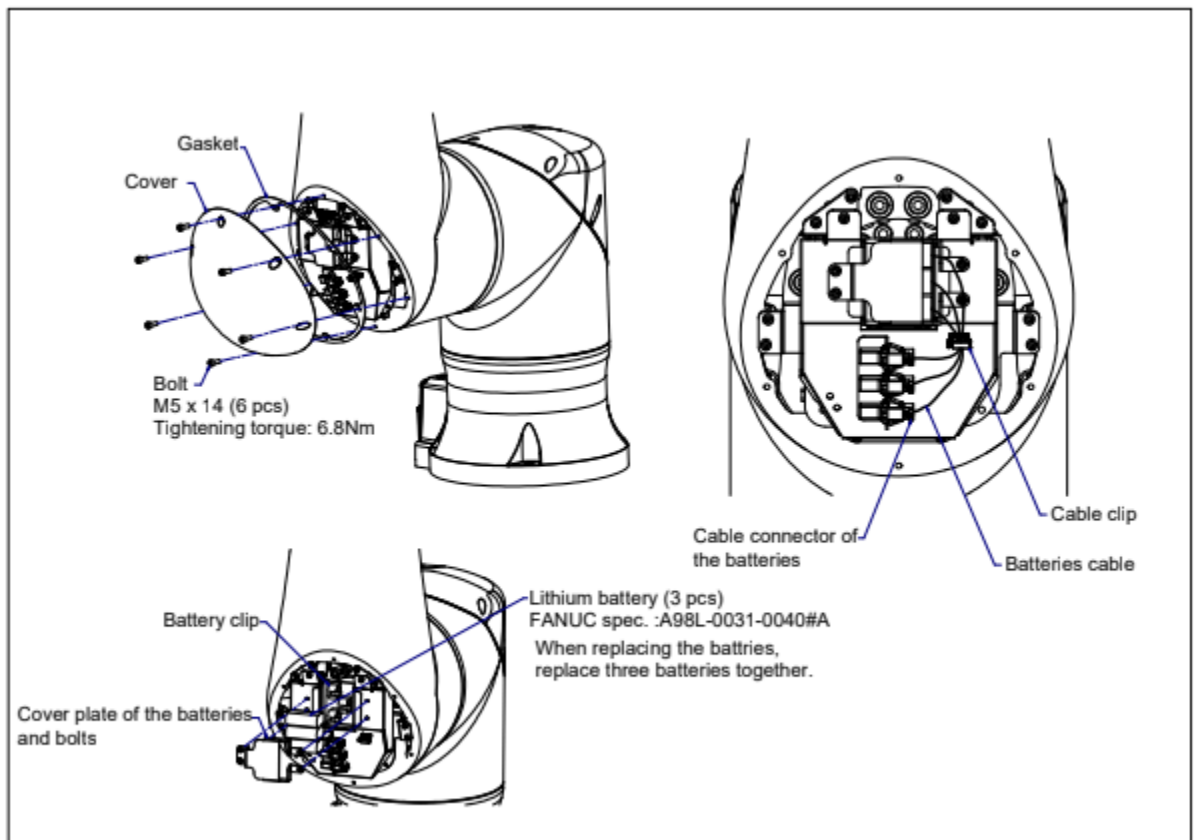

Fig. 2.1 (g) Replacing batteries (CRX-25iA)

The batteries can be purchased from the following sources:

- Directly from Fanuc
- Through us
- From McMaster-Carr (Part #7714N25) for expedited shipping: [Order from McMaster](#)

## 2. Professional Service:

Fanuc or our team can handle the replacement for you. (We can provide a quote if needed.)

**Key Points to Keep in Mind:**

- This battery replacement should be added to your annual maintenance schedule.
- After replacing the batteries, robot mastering may be required. Our team can assist you remotely with this if needed.
- The replacement typically takes less than 30 minutes when properly prepared.

For your reference, we've included instructional videos demonstrating the procedure on a similar model:

- [Video 1](#)
- [Video 2](#)

To avoid operational disruptions, please plan for this maintenance in advance. Delaying or improperly performing the replacement may result in extended downtime and the need for recalibration.